

BACnet WiFi Adapter (BACA-A)

MOUNTING AND OPERATING INSTRUCTIONS

Keep these instructions together with the device or with the equipment documentation!

PURPOSE:

The BACnet WiFi Adapter talks BACnet IP via WiFi and includes a router to BACnet MS/TP. It can be used for commissioning and debugging BACnet systems.

CYBER SECURITY:

After use, the BACnet WiFi Adapter should not be left on site and/or connected with the controller or BACnet bus. Rather, it should be disconnected and stored in a secure place. This is to prevent unauthorized system access.

0A. FRONT / REAR VIEWS

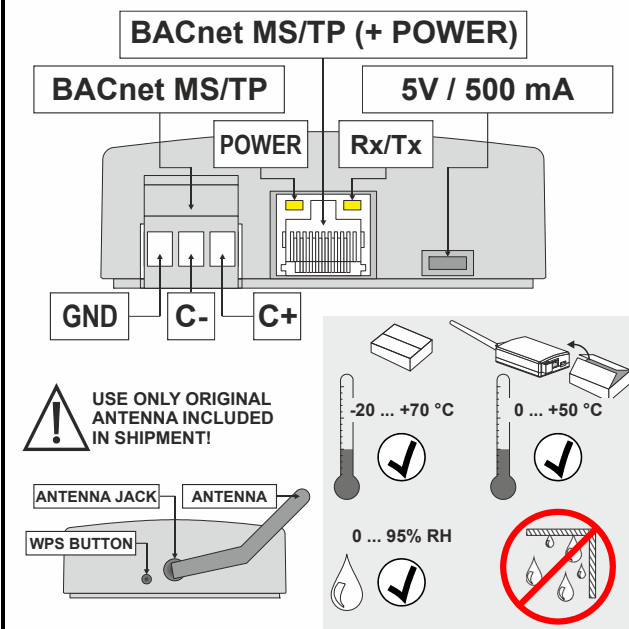

0B. POWER

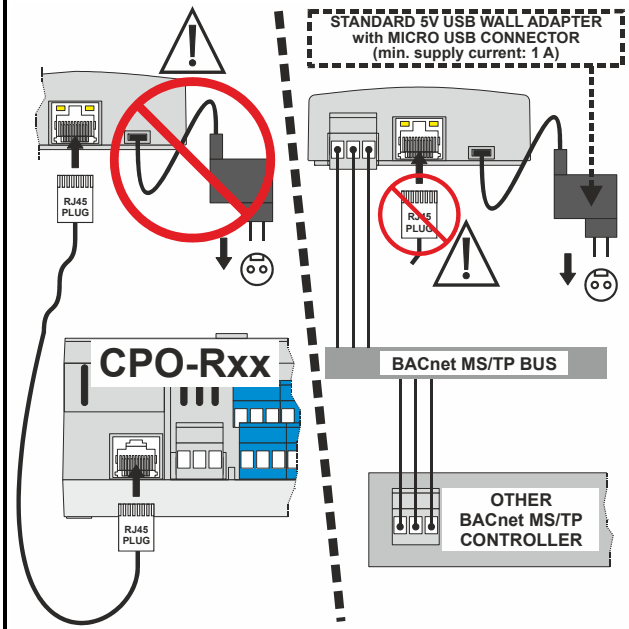

01. ESTABLISHING WIFI CONNECTION



02. SELECTING "WPS PUSH BUTTON"

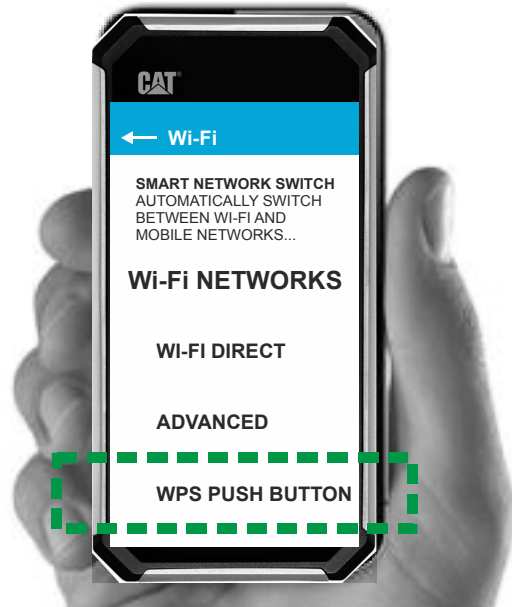

03. STARTING THE WPS PUSH BUTTON SET-UP

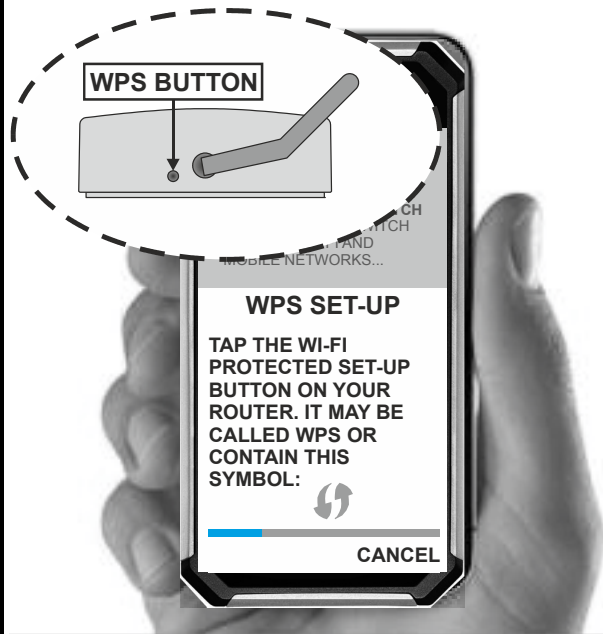

04. WPS SET-UP COMPLETE



05. WIFI CONNECTION ESTABLISHED



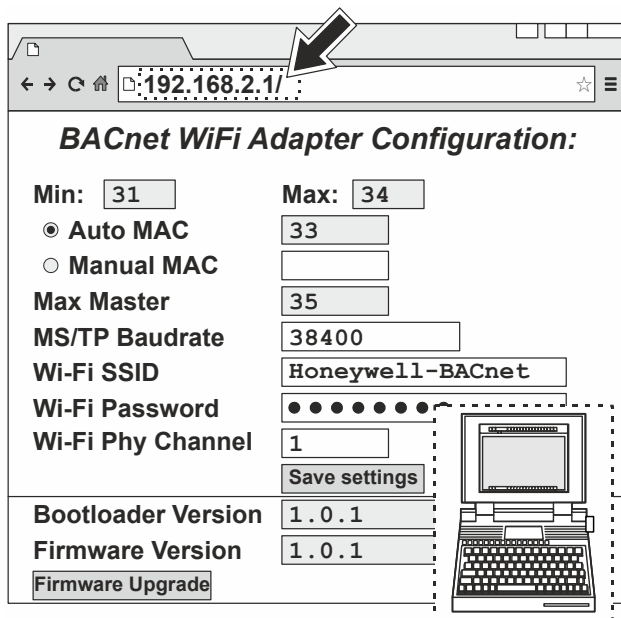

06. OPTIONAL CONFIGURATION



07. SEE ALSO:



-  **ComfortPoint Open CPO-Rxx ROOM CONTROLLERS...**
 - DATA SHEET (EN0B-0732GE51)
 - INSTALLATION & COMM. INSTRUCTIONS (EN1B-0591GE51)
-  **BACnet WiFi Adapter...**
 - PRODUCT DATA (EN0B-0733GE51)
 - MOUNTING & OPER. INSTRUCTIONS (MU1B-0592GE51)

08. SPECIFICATIONS

PURPOSE:	OPERATING CONTROL
CONSTRUCTION:	INDEPENDENTLY MOUNTED
ACTION TYPE:	1
POLLUTION DEGREE:	2
SOFTWARE CLASS:	A
RATED IMPULSE VOLTAGE:	500 V

Honeywell

Manufactured for and on behalf of the Environmental and Combustion Controls Division of Honeywell Technologies Sàrl, Rolle, Z.A. La Pièce 16, Switzerland by its Authorized Representative:

Automation and Control Solutions

Honeywell GmbH
Böblinger Strasse 17
71101 Schönaich, Germany
Phone +49 (0) 7031 637 01
Fax +49 (0) 7031 637 740
<http://ecc.emea.honeywell.com>

MU1B-0592GE51 R1215B

Subject to change without notice